

MEMBRANE CHECK VALVES

These valves have the same features of the other check valves, but they are made with anodised aluminium, which makes them particularly light. The seal is guaranteed by a EPDM membrane instead of the metal shutter with NBR seal.

For these features and for their modern design, they are recommended for pneumatic vacuum generators and, of course, on vacuum pumps.



Art.	R Ø	Ch	D Ø	H	Weight g
10 01 15	G1/4"	20	30	42	46
10 02 15	G3/8"	24	35	50	74
10 03 15	G1/2"	24	37	55	86
10 04 15	G3/4"	33	42	64	110
10 05 15	G1"	40	49	74	162

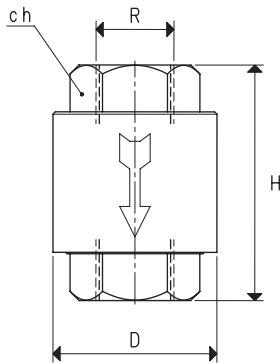

4

MANUAL 2-WAY MINIATURE VACUUM VALVES

These small manual valves are suited for intercepting vacuum on vacuum cup holders and any small utility in which solenoid valves cannot be installed. They feature a hexagonal nickel-plated brass body, a chromed brass ball shutter and a seal in plastic material to guarantee a perfect seal. A lever on the ball shutter, rotated by 90°, allows opening or closing the valve with no effort.



Art.	D Ø	Ch	E	F	H	Weight g
13 01 11	G1/4"	21	7	32	39	80
13 02 11	G3/8"	21	10	30	40	74
13 03 11	G1/2"	25	12	33	45	110

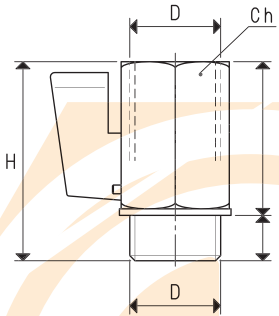

3D drawings available at www.vuototecnica.net

MANUAL 2-WAY VACUUM VALVES

These manual valves are used for intercepting vacuum in all those plants where solenoid valves cannot be installed.
They feature a die-cast nickel-plated brass body, a chromed brass ball shutter and teflon seals to guarantee perfect seal even at high temperatures.
A lever on the ball shutter, rotated by 90°, allows opening or closing the valve with no effort.

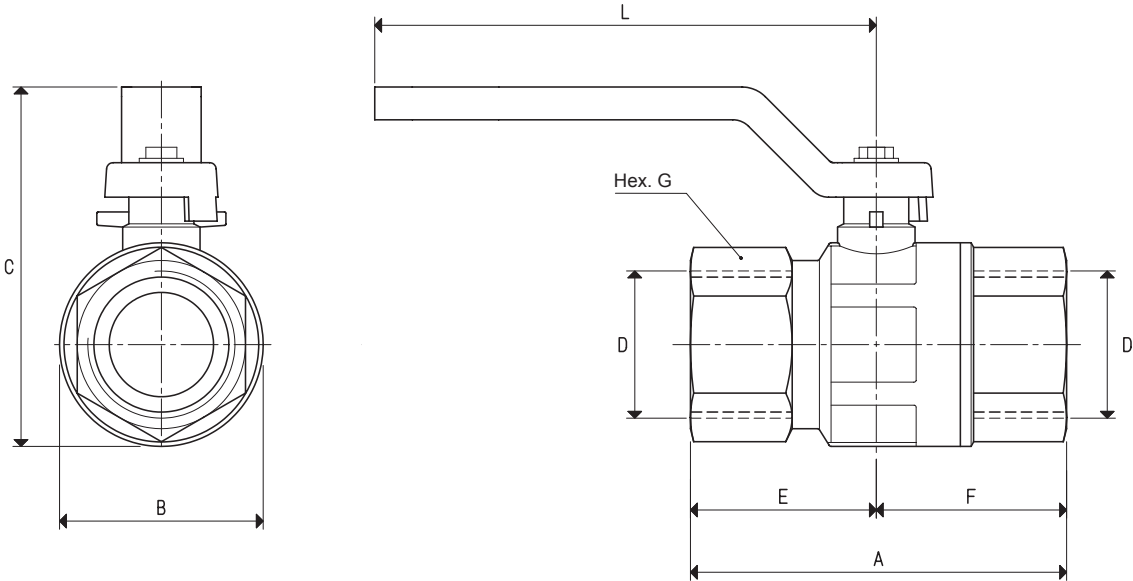

3D drawings available at www.vuototecnica.net

MANUAL 2-WAY VALVES

Art.	A	B	C	D Ø	E	F	G	L	Weight Kg
13 01 10	49	23	48	G1/4"	24	25	18	80	0.13
13 02 10	52	23	56	G3/8"	23	29	20	80	0.13
13 03 10	61	30	63	G1/2"	30	31	25	88	0.21
13 04 10	68	36	72	G3/4"	33	35	31	114	0.32
13 05 10	85	44	80	G1"	42	43	38	113	0.47
13 06 10	99	57	105	G1" 1/4	50	49	47	137	0.74
13 07 10	109	70	126	G1" 1/2	55	54	54	156	1.26
13 08 10	130	83	135	G2"	62	68	66	156	1.77
13 09 10	168	140	210	G3"	84	84	99	246	7.09

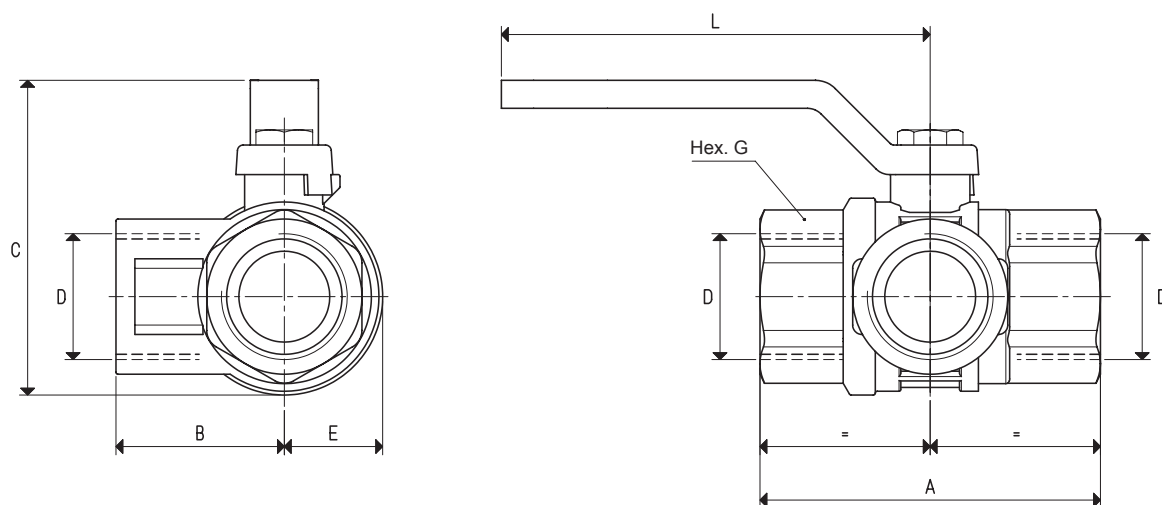
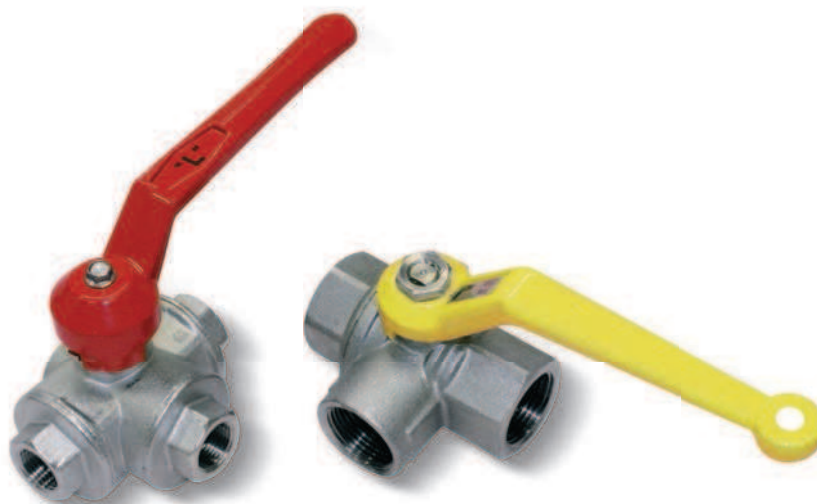

MANUAL 3-WAY VALVES

Art.	A	B	C	D Ø	E	G	L	Weight Kg
13 01 15	46	23	58	G1/4"	11	19	109	0.16
13 02 15	52	26	59	G3/8"	12	22	109	0.19
13 03 15	67	33	66	G1/2"	17	27	109	0.30
13 04 15	76	39	79	G3/4"	17	32	130	0.49
13 05 15	90	45	88	G1"	22	41	130	0.85
13 06 15	118	65	134	G1" 1/4	27	50	170	1.76
13 07 15	114	62	138	G1" 1/2	43	55	150	2.45