

ACCESSORIES AND SPARE PARTS FOR SOLENOID VALVES  
WITH LOW ABSORPTION COILS

Solenoid pilot valves with built-in low absorption electric coil

Solenoid pilot valves are small 3-way valves activated by a built-in electric coil able to manage the compressed air or the vacuum for piloting the solenoid valves.

The electric coil of the solenoid pilot valve is fully plasticised with synthetic resin, tight execution, insulation class F (up to 155 °C) compliant with VDE standards, with 3 mm 2-terminal electrical connections in compliance with EN 175301-803 (ex DIN 43650)-C.

Protection degree IP 54; IP 65 for inserted connector.

Allowed tolerance on the voltage nominal value: ±10%

Allowed tolerance on the frequency value: ±5%

Room temperature: from -10 to +45 °C

Fluid temperature: from -10 to +95 °C

Electric power: from 1 to 2 W

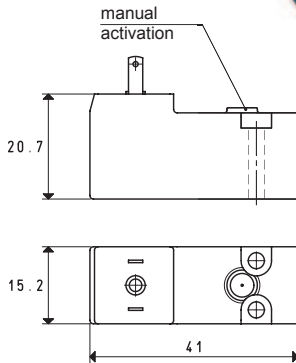

SOLENOID PILOT VALVES WITH BUILT-IN LOW ABSORPTION ELECTRIC COIL

Art.	Duty cycle	Power W	Electric voltage Volt	Pressure bar (g)		Weight g
				min	max	
00 07 301	100%	1	12 / 50 - 60Hz	0	7	32
00 07 302	100%	1	24 / 50 - 60Hz	0	7	32
00 07 303	100%	2	12 / CC	0	7	32
00 07 304	100%	2	24 / CC	0	7	32
Solenoid valves art. 07 01 13 - 07 02 13 - 07 03 13 - 07 04 13 - 07 05 13 - 07 06 13 07 03 13 LP - 07 04 13 LP - 07 05 13 LP - 07 06 13 LP						
00 07 305	100%	1	12 / 50 - 60Hz	0	10	32
00 07 306	100%	1	24 / 50 - 60Hz	0	10	32
00 07 307	100%	2	12 / CC	0	10	32
00 07 308	100%	2	24 / CC	0	10	32
Solenoid valves art. 07 03 43 - 07 04 43 - 07 05 43						

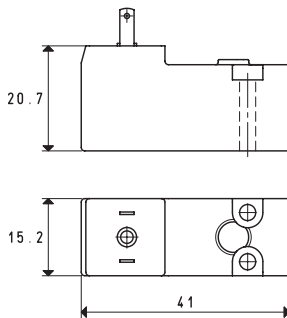

BISTABLE IMPULSE SOLENOID PILOT VALVE WITH BUILT-IN ELECTRIC COIL

Art.	Duty cycle	Power W	Electric voltage Volt	Pressure bar (g)		Weight g
				min	max	
00 07 309	100%	1	12 / CC	0	8	30
00 07 310	100%	1	24 / CC	0	8	30
Solenoid valves art. 07 01 53 - 07 02 53 - 07 03 53 - 07 04 53 - 07 05 53 - 07 06 53 07 03 53 LP - 07 04 53 LP - 07 05 53 LP - 07 06 53 LP						
00 07 311	100%	1	12 / CC	0	5	30
00 15 297	100%	1	24 / CC	0	5	30
Solenoid valves art. 07 03 63 - 07 04 63 - 07 05 63						



VALVE - INTERFACE				
Art.	Pressure (bar)		Weight g	Solenoid valves art.
	min	max		
00 15 154	0	7	20	07 06 13 - 07 06 13 LP 07 06 53 - 07 06 53 LP

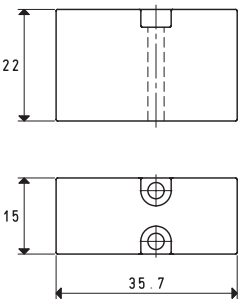

MICRO CONNECTORS EN 175301 - 803 (EX DIN 43650) - C,  
FOR SOLENOID PILOT VALVE COILS

Connectors are essential elements for bringing electricity to solenoid pilot valves with built-in low absorption coil. They are available in the plug version, with a LED for signalling the presence of voltage and, upon request, with anti-interference circuits, with protection against overvoltage and polarity inversion. All connectors provide full protection against water jets, according to EN 60529 (protection class IP 65), when correctly installed.

They also meet VDE 0110-1 /89 standard, working voltage up to 250 V, overvoltage category II, degree of use 3 regarding insulation class.

In all contacts, a snap joint between contact holders and the external protection guarantees a safe locking and easy assembly.

A safe locking is essential for guaranteeing the operator full protection when handling the connector.

The contact holder can be easily extracted from its casing simply using a screwdriver. This operation also allows orienting the earthing contact in the desired direction.

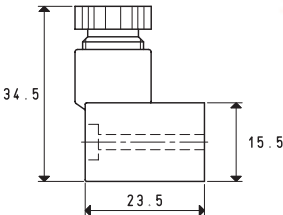

Art.	Contact nominal capacity	Conductor max section	Operating temperature	Ø cable	Weight	Notes	Solenoid pilot valve art.
	A	mm	°C	mm	g		
00 15 157	6 ÷ 10	0.75	-40 ÷ +90	4 ÷ 6	8	with LED	All