

## LOCKING PLATES, FOR OCTOPUS GRIPPING BARS WITHOUT VACUUM GENERATOR

The locking plate with manifold described in this page has been designed to connect an OCTOPUS gripping bar to a remotely installed vacuum generator or to an alternative vacuum source.

This anodised aluminium plate is fixed with screws to the body of the OCTOPUS bar, instead of the generator. The manifold is equipped with connectors for a direct connection to the OCTOPUS bar, to the generator or to the alternative vacuum source, as well as to vacuum level reading and control devices. The unused connections can be closed with special metal caps which they are equipped with.

The locking plate with manifold is suited for any kind of OCTOPUS gripping bar that uses PVP 12 MX and PVP 25 MX vacuum generators.

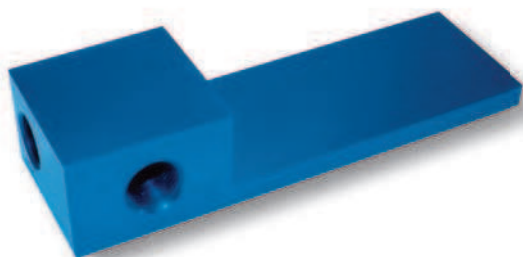

Art.	For OCTOPUS gripping bars
00 BO 07	BO 08 60 X
	BO 08 80 X
	BO 12 60 X
	BO 12 80 X
	BO 12 100 X
	BO 12 120 X

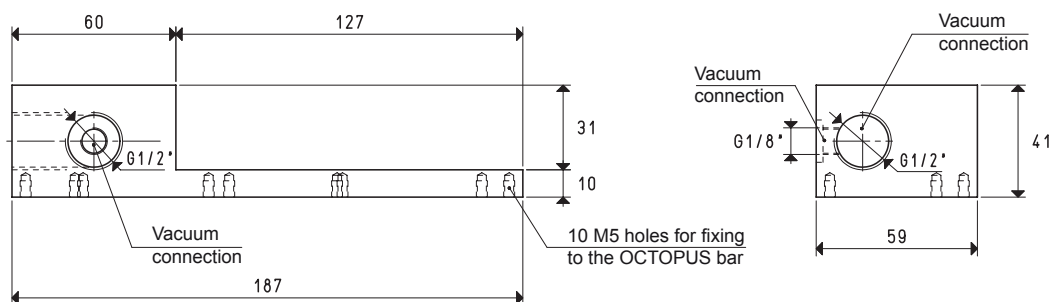

## LOCKING PLATES FOR, OCTOPUS GRIPPING BARS WITHOUT VACUUM GENERATOR

The locking plate described in this page has been created to close the suction holes on the OCTOPUS bar body and left free by the removal of the vacuum generator.

This anodised aluminium plate is fixed with screws to the OCTOPUS bar instead of the generator. The gasket provides perfect seal. The locking plate with manifold is suited for any kind of OCTOPUS gripping bar that uses PVP 12 MX and PVP 25 MX vacuum generators.

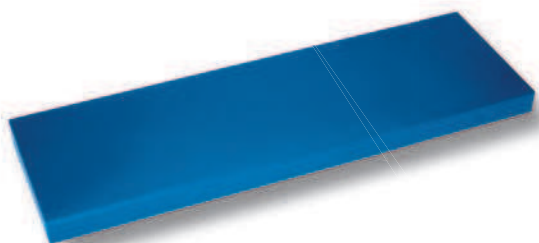

Art.	For OCTOPUS gripping bars
00 BO 06	BO 08 60 X
	BO 08 80 X
	BO 12 60 X
	BO 12 80 X
	BO 12 100 X
	BO 12 120 X

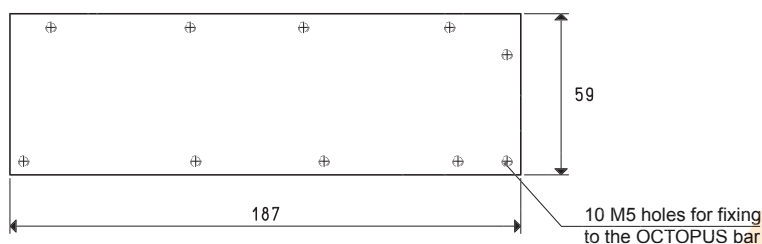

## ACCESSORIES AND SPARE PARTS FOR OCTOPUS GRIPPING SYSTEMS AND BARS

### Digital vacuum switch with 1/8" axial gas coupler



Art.	Description
12 10 10	Digital vacuum switch

### Electric cable with axial connector



Art.	Description
00 12 20	Digital vacuum switch electric connection cable with axial connector

### Electric cable with radial connector



Art.	Description
00 12 21	Digital vacuum switch electric connection cable with radial connector

### Vacuum gauge Ø 40 mm with 1/8" axial gas coupler



Art.	Description
09 03 15	Vacuum gauge

### Pressure gauge Ø 40 mm with 1/8" axial gas coupler



Art.	Description
09 03 25	Pressure gauge

## Silencer



Art.	For generator art.
SSX 1/4"	PVP 25 MX

## Sealing kit and reed valves

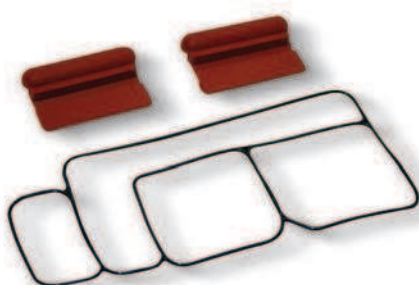

Art.	For generator art.
00 KIT PVP 25 MX	PVP 25 MX

## Sealing kit and disc valves

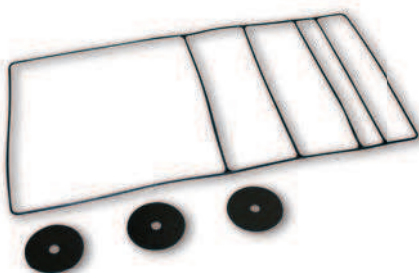

Art.	For generator art.
00 KIT PVP 100 M	PVP 100 M
00 KIT PVP 140 M	PVP 140 M
00 KIT PVP 170 M	PVP 170 M
00 KIT PVP 200 M	PVP 200 M

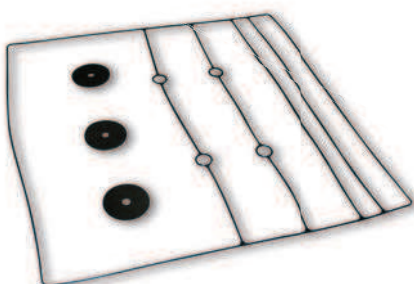

Art.	For generator art.
00 KIT PVP 150 MD	PVP 150 MD
00 KIT PVP 300 MD	PVP 300 MD
00 KIT PVP 450 MD	PVP 450 MD

# SPARE PARTS FOR OCTOPUS GRIPPING SYSTEMS AND BARS

## Stainless steel disc filtre

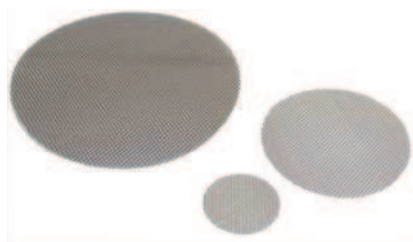

Art.	D	For OCTOPUS system
	Ø	Ø
<b>00 S0 05</b>	25	SO 15 20 - BO 08 60 - BO 08 80 BO 12 60 - BO 12 80 - BO 12 100 - BO 12 120
<b>00 S0 10</b>	50	SO 20 30 - SO 20 40 - SO 20 60 - SO D0 35
<b>00 S0 14</b>	80	SO 30 30 - SO 30 40 - SO 30 50 - SO 40 40 SO 40 60 - SO D0 50 - SO 40 100 - SO 60 80 SO 60 120 - SO 80 100

## Cup supports

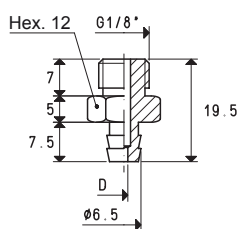

Art.	D	Weight	Support material	For cup art.
	Ø	g		
<b>00 08 157</b>	1.5	4	aluminium	01 18 29
<b>00 08 178</b>	2.5	4	aluminium	01 18 29

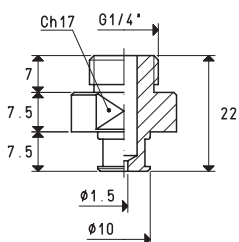

Art.	Weight	Support material	For cup art.
	g		
<b>00 08 158</b>	8	aluminium	01 40 42

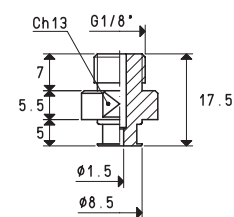

Art.	Weight	Support material	For cup art.
	g		
<b>00 08 170</b>	4	aluminium	01 20 23

## Shut-off valves

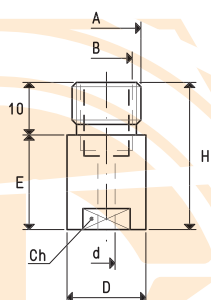

Art.	A	B	d	D	E	H	Ch	Weight	Support material
	Ø	Ø	Ø	Ø				g	
<b>14 01 06</b>	G1/4"	G1/8"	3.25	15	18	28	12	10	aluminium
<b>14 01 07</b>	G3/8"	G1/4"	4.50	20	25	35	17	24	aluminium