

SUPPORTS WITH RETRACTABLE STRIKING PIN

1



These supports with retractable striking pins have been designed to allow a quick centering of the load to be clamped to the machine work surface via the cups. The striking pin is solidly connected to a piston and it is activated by the vacuum while retracting and while remaining in its housing and also by a stainless steel spring while coming out.

These supports are mechanically fixed to the work surface.

The striking pin is made with plastic material, while the support is made with anodised aluminium.

As a standard they are equipped with a quick coupling for vacuum connection.

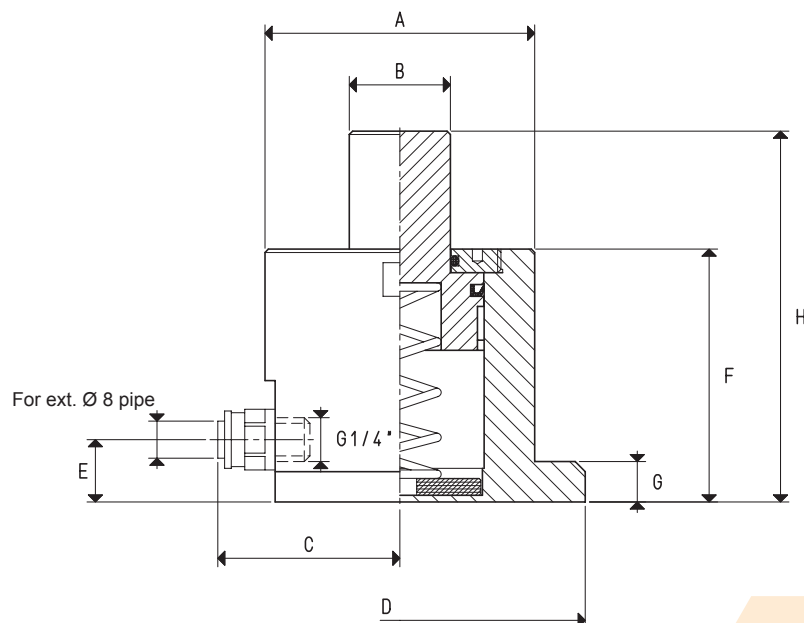
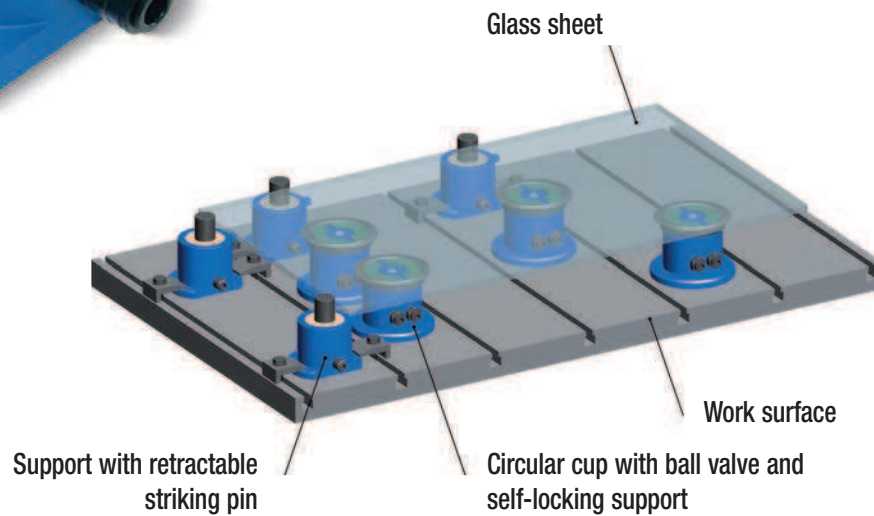

SUPPORTS WITH RETRACTABLE STRIKING PIN

| Art. | A Ø | B Ø | C | D Ø | E | F | G | H | Weight Kg |
|----------|--------|--------|----|--------|----|-----|----|-----|--------------|
| 23 01 10 | 80 | 30 | 53 | 110 | 18 | 45 | 12 | 63 | 0.690 |
| 23 01 15 | 80 | 30 | 53 | 110 | 13 | 64 | 12 | 99 | 0.846 |
| 23 02 10 | 80 | 30 | 53 | 110 | 18 | 75 | 12 | 110 | 0.956 |
| 23 05 10 | 80 | 30 | 53 | 110 | 18 | 110 | 12 | 180 | 1.280 |

Conversion ratio: inch = $\frac{\text{mm}}{25.4}$; pounds = $\frac{\text{g}}{453.6}$ = $\frac{\text{Kg}}{0.4536}$